

# IPC6385-VRZ

## 4K UHD Intelligent Network IR Fixed Dome Camera

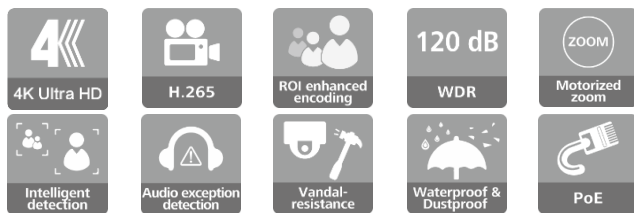

Indoor



### Features

- Up to 4K(3840×2160) UHD resolution
- H.265 video compression for 4K@30fps streaming to save disk space and network usage
- Ultra Wide Dynamic Range (WDR) up to 120 dB for superb detail in scenes with high contrast lighting
- Highlight suppression, preventing key information loss in strong light conditions
- Intelligent defog, significantly improving visibility
- Intelligent behavior analytics, Face detection
- Advanced cyber-security measures, preventing against tampering, eavesdropping and virus spreading
- Ultra wide operating voltage range: ±25%

### Dimension

Unit: mm

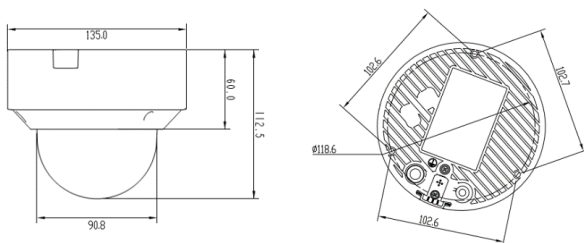

### Optional Accessories



Pendant-mount bracket  
DTS-08C



Wall-mount bracket  
DTS-09C

### Specifications

Product model	IPC6385-VRZ
<b>Camera</b>	
Image sensor	1/2.5" 8MP progressive scan CMOS
Effective pixels	3840 × 2160
Min. Illumination	Color: 0.08lux (F1.5, AGC ON) B/W : 0.08lux (F1.5, AGC ON), 0 lux with IR on
Day and night	Auto/Color/Monochrome (Infrared-cut filter)
Shutter time	1/3s ~1/68250s
Gain control	Auto/Manual
WDR	120dB
BLC	Supported
Highlight suppression	Supported
Image stabilization	Electronic image stabilization
Defog	Automatic/Manual
White balance	Auto/Auto-tracking/Manual/One-off calibration
Digital noise reduction	2D/3D DNR
IR coverage	30m
<b>Lens</b>	
Focal length	4.1-12.8mm, horizontal field of view: 88°(Wide) ~ 28°(Tele)
Aperture	F1.5 to F3.3
Auto-Iris	P-iris
Camera angle adjustment	Pan: 0°~356°,Tilt: 0°~75°,Rotation: 0°~ 356°
<b>Function</b>	
Video compression	H.265/H.264/MJPEG
Frame rate	60Hz : 30/20 to 1fps ; 50Hz : 25/20 to 1fps
Video bit rate	32Kbps to 16Mbps
Video function	ROI, regional cropping, picture overlay, privacy masks
Audio compression	G.711a/G.711u/G.726/OPUS
Stream transmission	Treble streams, super error concealment, traffic shaping
System integration	ONVIF Profile S/G, Genetec Protocol v1.00, HUAWEI SDK
Network protocol	TCP , UDP , IPv4 , IPv6 , DHCP , DHCPv6 , DNS , DNSv6 , ICMP , ICMPv6 , IGMP , HTTP , HTTPS , FTP , SFTP , RTP , RTSP , RTCP , SIP , ARP , SSL , NTP , SNMP ( V1/V2/V3 ) , 802.1x , QoS , DDNS , SMTP
Advanced cyber-security	PKI-CA, SSL/UDPS VPN tunnel encryption, VPN tunnel access isolation (These features requires support from Huawei network security solutions.)
Basic cyber-security	User 3-level authentication, 802.1x authentication, and EAP-TLS, HTTPS digital certificate, IP address filtering
Media security	AES256 encryption algorithm, and Digital Watermark
Intelligent analytics	Crossing line detection, abandoned/removed object detection, loitering detection, intrusion detection, face detection, color recognition, vehicle and pedestrian classification
Intelligent detections	Motion detection, Tampering detection, over-temperature detection, local storage failure detection, exception audio detection, Audio loss detection
Alarm actions	External alarm output, SD card recording, snapshot and pre-recording
<b>Interface</b>	
Ethernet interface	1x 10M/100M RJ-45 Ethernet interface
Alarm interface	1-channel alarm input and 1-channel alarm output
Audio interface	1-channel audio input and 1-channel audio port
Analog video interface	1-channel CVBS signal only for installation (BNC connector)
Memory interface	1x MicroSD slot supporting memory card up to 128 GB
<b>General</b>	
Power supply	DC12V±25%, AC24V±25%, DC24V±25%, PoE(IEEE 802.3at) DC/AC supply can be hot standby for PoE supply
Power consumption	Typ.4.8W , Max.13.9W
Operating temperature	-40 to 60°C
Operating humidity	5% to 95% (non-condensing)
Railway application	Complies with EN 50121-4 and EN 50125-3
Surge suppression	6kV surge voltage, complying with IEC 61000-4-5
IP protection class	IP67, complying with IEC 60529
Vandal-proof Class	IK10 vandal-proof metal casing, complying with IEC 62262
Anti-corrosion	Satisfies 10 days salt spray test, complying with IEC60068-2-11
Net weight	1.20 kg
Gross weight	1.40 kg
Physical dimensions	φ135×112.5 mm
Packing dimensions	260.0×195.0×148.0 mm